

LEFT SIDE VIEW

FRONT VIEW

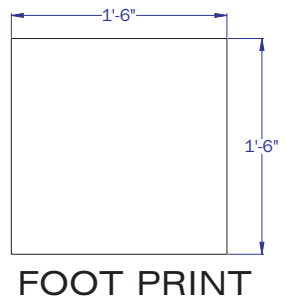

FOOT PRINT

MODEL MDU INCLUDES		ACCESSORY OPTIONS	
PART ID	DESCRIPTION	PART ID	DESCRIPTION
0112	LOCKED CHEST, SS HEAD, DELIVERY CHUTE, LOCK AND KEYS, SIGNS: "BOOK DROP" & "LIFT TO OPEN" CUSTOM SIGNS AVAILABLE AT NO ADDITIONAL CHARGE	0608	LOCKABLE LIFT PLATE INCLUDES LOCK BAR, PAD LOCK, AND 2 KEYS
		1217	MEDIA SLOT RESTRICTOR PLATE ADJUSTABLE FROM 1/2" TO 2 3/4" X 13 1/3" WIDE. PLATE ATTACHES BEHIND HCU SS HEAD.
		1114	COLOR COATED ARMOR ENTIRE STAINLESS STEEL HEAD, CHUTE, AND CABINET ONE COLOR

SS HEAD & DELIVERY CHUTE DETAIL

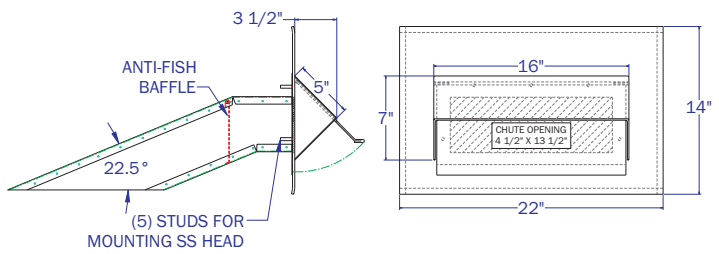

WALL DEPTH ELEVATIONS
ASSUMES SAME INTERIOR AND EXTERIOR GRADE

WALL DEPTH	C.L OF ROUGH OPENING
4" - 6"	34 15/16" - 35 3/4"
6" - 8"	35 3/4" - 36 9/16"
8" - 10"	36 9/16" - 37 7-16"
10" - 12"	37 7/16" - 38 1/4"
12" - 14"	38 1/4" - 39 1/16"
14" - 16"	39 1/16" - 39 7/8"
16" - 18"	39 7/8" - 40 3/4"
18" - 20"	40 3/4" - 41 9/16"
20" - 22"	41 9/16" - 42 3/8"
22" - 24"	42 3/8" - 43 3/16"

THE INFORMATION CONTAINED IN THIS DRAWING IS THE SOLE PROPERTY OF AMERICAN BOOK RETURNS. ANY MISUSE IN PART OR AS A WHOLE IS STRICTLY PROHIBITED BY AMERICAN BOOK RETURNS.				AMERICAN BOOK RETURNS 120 6TH AVE. NORTH ST. CLOUD, MN 56303 320-253-3044		TITLE MDU_CUT SHEET			
						PART NAME MODEL MDU			
1	FOOT PRINT IS NOW 18" X 18"	02-15-10	JRS	TOL: UNLESS OTHERWISE SPECIFIED ANGLES: ±1° .XX±.030 .XXX±.010		SHEET	PART ID # 0112	SCALE NTS	REV 1
REV	DESCRIPTION RELEASE	DATE 04-23-09	BY JRS						